

**MEETING**

**FINCHLEY & GOLDERS GREEN AREA COMMITTEE**

**DATE AND TIME**

**WEDNESDAY 17TH OCTOBER, 2018**

**AT 7.00 PM**

**VENUE**

**HENDON TOWN HALL, THE BURROUGHS, LONDON NW4 4BQ**

**TO: MEMBERS OF FINCHLEY & GOLDERS GREEN AREA COMMITTEE (Quorum 3)**

Chairman: Councillor Shimon Ryde BSc (Hons)

Vice Chairman: Councillor Rohit Grover

**Councillors**

Councillor Dean Cohen BSc (Hons)

Councillor Ross Houston

Councillor Anne Hutton

Councillor Arjun Mittra

Councillor Jennifer Grocock

**Substitute Members**

Councillor Geof Cooke

Councillor Kath McGuirk

Councillor John Marshall MA  
(Hons)

Councillor Peter Zinkin

Councillor Alison Moore

Councillor Eva Greenspan

Councillor Melvin Cohen LLB

In line with the Constitution's Public Participation and Engagement Rules, requests to submit public questions or comments must be submitted by 10AM on the third working day before the date of the committee meeting. Therefore, the deadline for this meeting is Friday 12 October 2018. at 10AM. Requests must be submitted to Anita Vukomanovic 020 8359 7034 [anita.vukomanovic@barnet.gov.uk](mailto:anita.vukomanovic@barnet.gov.uk)

**You are requested to attend the above meeting for which an agenda is attached.**

**Andrew Charlwood – Head of Governance**

Governance Services contact: Anita Vukomanovic 020 8359 7034

[anita.vukomanovic@barnet.gov.uk](mailto:anita.vukomanovic@barnet.gov.uk)

Media Relations Contact: Gareth Greene 020 8359 7039

**ASSURANCE GROUP**

*Please consider the environment before printing. The average Print Cost for this Agenda is £10.37 per copy.*

## ORDER OF BUSINESS

Item No	Title of Report	Pages
1.	Minutes of last meeting	5 - 12
2.	Absence of Members (If any)	
3.	Declaration of Members' Disclosable Pecuniary interests and Non Pecuniary interests (If any)	
4.	Report of the Monitoring Officer (If any)	
5.	Public Comments and Questions (If any)	
6.	Matters referred from the Finchley and Golders Green Area Residents Forum (If any)	13 - 16
7.	Petitions (if any)	
8.	Area Committee Grants Funding	17 - 24
9.	Members' Items (if any)	
10.	Members' Items - Area Committee Funding Applications (if any)	25 - 34
11.	Alexandra Grove/Ballards Lane, N12 Junction - Pedestrian Improvements	35 - 46
12.	The Vale junction with Granville Road and Wayside, NW11	47 - 54
13.	Somerton Road NW2 - Width restriction - Feasibility Study	To Follow
14.	Forward Work Programme	55 - 60
15.	Any item(s) the Chairman decides are urgent	

### FACILITIES FOR PEOPLE WITH DISABILITIES

Hendon Town Hall has access for wheelchair users including lifts and toilets. If you wish to let us know in advance that you will be attending the meeting, please telephone Anita

Vukomanovic 020 8359 7034 anita.vukomanovic@barnet.gov.uk. People with hearing difficulties who have a text phone, may telephone our minicom number on 020 8203 8942. All of our Committee Rooms also have induction loops.

### **FIRE/EMERGENCY EVACUATION PROCEDURE**

If the fire alarm sounds continuously, or if you are instructed to do so, you must leave the building by the nearest available exit. You will be directed to the nearest exit by uniformed custodians. It is vital you follow their instructions.

You should proceed calmly; do not run and do not use the lifts.

Do not stop to collect personal belongings

Once you are outside, please do not wait immediately next to the building, but move some distance away and await further instructions.

Do not re-enter the building until told to do so.

This page is intentionally left blank

# Decisions of the Finchley & Golders Green Area Committee

13 June 2018

Members Present:-

AGENDA ITEM 1

Councillor Shimon Ryde (Chairman)  
Councillor Rohit Grover (Vice-Chairman)

Councillor Dean Cohen  
Councillor Anne Hutton

Councillor Arjun Mittra  
Councillor Kath McGuirk  
Councillor Jennifer Grocock

Also in attendance

Councillor John Marshall    Councillor Geof Cooke

Apologies for Absence  
Councillor Ross Houston

## 1. MINUTES OF LAST MEETING

RESOLVED that the minutes of the meeting dated 15 February 2018 were agreed as a correct record.

## 2. ABSENCE OF MEMBERS (IF ANY)

Apologies for absence were received from Councillor Ross Houston, who was substituted by Councillor Kath McGuirk.

## 3. DECLARATION OF MEMBERS' DISCLOSABLE PECUNIARY INTERESTS AND NON PECUNIARY INTERESTS (IF ANY)

Councillor Anne Hutton declared a non-pecuniary interest in relation to Agenda Item 13 – Church Lane, N2 – Feasibility Study, by virtue of living near Church Lane.

Councillor Kath McGuirk Councillor Anne Hutton and Councillor Arjun Mittra declared a non pecuniary interest in relation to Agenda Item 13 – Church Lane, N2 – Feasibility Study, by virtue of the Finchley and Golders Green Constituency Labour Party Office being located on Church Lane, N2.

Councillor Rohit Grover declared a non pecuniary interest in relation to Agenda Items 11 (Road Safety Measures around Menorah Primary School) and Agenda Item 12 (Hampstead Way) by virtue of living nearby.

Councillor Dean Cohen declared a non pecuniary interest in relation to Agenda Items 11 (Road Safety Measures around Menorah Primary School) by virtue of his children attending Menorah Primary School.

## 4. REPORT OF THE MONITORING OFFICER (IF ANY)

None.

**5. PUBLIC COMMENTS AND QUESTIONS (IF ANY)**

The Committee received a public comment from Mr. Charles Harvey in relation to Agenda Item 13 – Road Safety Measures around Menorah Primary School. The Committee noted the comment and asked questions of Mr. Harvey.

**6. MATTERS REFERRED FROM THE FINCHLEY AND GOLDERS GREEN AREA RESIDENTS FORUM (IF ANY)**

The Chairman introduced the item and invited Mr. Tom Shanahan to present his petition.

Mr. Shanahan introduced the petition which sought to petition the Council to make Churchfiled Avenue N12 a one way street, with entry only at the Hight Road end.

The Committee noted Mr. Shanahan's comments and asked questions.

Following discussion, the Committee determined to ask Officers to meet with Woodhouse Ward Members and residents, the petitioner and residents to look at a scheme and to commit £3,000 initially to start to develop a scheme that would come back to a future meeting of this Committee.

**RESOLVED that the Committee note the petition and issue instructions as set out above.**

**7. PETITIONS (IF ANY)**

None.

**8. AREA COMMITTEE GRANTS FUNDING**

The Chairman introduced the report, which updated the Committee on the budget allocations for the Finchley and Golders Green Area Committee for Community Infrastructure Levy funding.

The Committee noted that there was a carryover from the previous year and the total available for this year is £158,000.

RESOLVED that:

- 1. That the Finchley & Golders Green Area Committee notes the amount available for allocation during 2018/19, as set out in Appendix 1**
- 2. That the Finchley & Golders Green Area Committee notes the amount of re-allocated underspends & overspends in Section 2.1**

**9. MEMBERS' ITEMS (IF ANY)**

None.

**10. MEMBERS' ITEMS - AREA COMMITTEE FUNDING APPLICATIONS (IF ANY)**

A – Member’s Item in the name of Councillor John Marshall: Lighting of the Central Square Minyan: To consider funding for the lighting of the Central Square Minyan.

Further to consideration the Committee unanimously RESOLVED:

**To approve funding of up to £5000 for the investigation and implementation of lighting in Central Square Minyan.**

B – Member’s Item in the name of Councillor Geof Cooke: Legible London signage for pedestrians around North Finchley

Further to consideration the Committee unanimously RESOLVED:

**To approved funding of up to £5,000 for Legible London signage for pedestrians around North Finchley.**

C – Member’s Item in the name of Councillor Arjun Mittra: Request for zebra crossing to connect Childs Hill Park and Basing Hill Park

Further to discussion, the committee agreed to request that Officers look at the feasibility of where such a crossing could be located and once that has been done, for Committee to consider how this can be progressed. The Committee therefore RESOLVED:

**To approve £3,000 funding to begin initial investigations close to Granville Road, Childs Hill and Basing Hill Park.**

D - Member’s Item in the name of Councillor Alison Moore: Assessment and Enabling Works for a Forest School at Tarling Road Open Space

Further to discussion, the Committee RESOLVED:

**To request that Ward Councillors and Residents meet with Greenspaces to develop a strategy and to allocate a budget of £5,000 for the CIL fund.**

E – Member’s Item in the name of Councillor Shimon Ryde – Wheelie – Funding for 10 additional e-bikes and associated items

**Further to consideration, the Committee unanimously RESOLVED to approve funding of £7,400.39 for the funding of 10 additional e-bikes and associated items and for a power source.**

**THE CHAIRMAN ANNOUNCED A VARIATION TO THE AGENDA ORDER, WITH THE CHURCH LANE, N2 - FEASIBILITY STUDY, BEING CONSIDERED NEXT.**

## **11. CHURCH LANE, N2- FEASIBILITY STUDY**

At the invitation of the Chairman, Mr. Lecordier introduced the paper, which detailed the results of a feasibility study to investigate measures to reduce traffic problems in Church Lane, N12.

Mr. Lecordier noted that vertical traffic calming measures are generally not favoured in the Borough but are appropriate in certain situations.

Following the consideration of the report, the Chairman MOVED to the vote on Recommendation 1 as set out in the report. Votes were recorded as follows:

For	7
Against	0
Abstentions	0

The Chairman MOVED to the vote on Recommendation 2 as set out in the report. Votes were recorded as follows:

For	6
Against	1
Abstentions	0

The Chairman MOVED to the vote on Recommendation 3 as set out in the report. Votes were recorded as follows:

For	6
Against	1
Abstentions	0

The Chairman MOVED to the vote on Recommendation 4 as set out in the report. Votes were recorded as follows:

For	6
Against	1
Abstentions	0

The Chairman MOVED to the vote on Recommendation 5 as set out in the report. Votes were recorded as follows:

For	6
Against	1
Abstentions	0

RESOLVED that:

- 1. That the Finchley and Golders Green Area Committee note the review of the improvements outlined in this report and the appendices to this report and depicted on drawing BC/001411-04-DESIGN-01.**
- 2. That the Finchley and Golders Green Area Committee give instruction to the Strategic Director for Environment to carry out a consultation on the recommended proposals**
- 3. That subject to no objections being received to the consultation, referred to in 2 above, the Finchley and Golders Green Area Committee instruct the Strategic Director for Environment to introduce the proposals.**
- 4. That the Finchley and Golders Green Area Committee agree that if any objections are received as a result of the consultation, referred to in 3 above, the Strategic Director for Environment will consider and determine whether**



the agreed proposal should be implemented or not, and if so, with or without modification.

5. That the Finchley and Golders Green Area Committee agree to allocate the funding of £12,100 for the agreed Option (CIL from this year's CIL Area Committee budget) to design and introduce the approved Option.

Following the conclusion of the vote on this item, Councillor Arjun Mittra left the meeting at 8:01 pm.

## **12. ROAD SAFETY MEASURES AROUND MENORAH PRIMARY SCHOOL, NW11- REVIEW OF CONSULTATION RESPONSES FEBRUARY 2018 AND NEW PROPOSALS**

Mario Lecordier, Interim Strategic Lead Commissioner – Highways introduced the report which detailed the results of the consultations for the Road Safety Measures around Menorah Primary School Scheme which was approved by the Committee on 14 November 2017.

Following the consideration of the report, the Committee unanimously RESOLVED:

1. That the Finchley and Golders Green Area Committee notes the results of the statutory consultation as set out in Appendix B in this report.
2. Having considered the objections, the Finchley and Golders Green Area Committee notes the alternative options set out in this report.
3. That the Finchley and Golders Green Area Committee approves that the preferred Option 1 for the uncontrolled crossings at The Drive and 20 mph speed zone and authorises that the Strategic Director for Environment should instruct officers to progress to public consultation and detail design.
4. That the Finchley and Golders Green Area Committee agree that if any objections are received as a result of the statutory consultations, referred to in recommendation 3, the Strategic Director for Environment will consider and determine whether the agreed Options should be implemented or not, and if so, with or without modification.
5. That the Committee notes that the funding for the agreed Option is included in the Local Implementation Plan (LIP) 2018/19 budget to introduce the approved Option.

## **13. HAMPSTEAD WAY, NW11- FEASIBILITY STUDY**

At the invitation of the Chairman, Mr. Lecordier introduced the report which detailed the results of a feasibility study which involved investigating measures to reduce the traffic problems on Hampstead Way, NW11.

Responding to a question from a Member, Mr. Lecordier noted an error in Table 5 – Cost Estimate Option2, which should read a total of £2,500 and not £24,750. The total estimated cost would therefore be £25,000. and the figure referred to in Recommendation 6 should read £25,000 for both options.

Councillor Rohit Grover MOVED the following amendment to Recommendation 2 which was SECONDED by Councillor Jennifer Grocock.

2. **Having considered both options that the Finchley and Golders Green Area Committee approve the Officer preferred Option 1 and 2 –Installation of informal crossing point, and removal of 20 metres of parking which reflects option 2 to be progressed to detailed design, as outlined in drawing BC/001411-DESIGN-01.**

Councillor Rohit Grover MOVED the following amendment to Recommendation 5 which was SECONDED by Councillor Jennifer Grocock.

**That the Finchley and Golders Green Area Committee agree that if any objections are received as a result of the consultation, referred to in recommendation 3, the Strategic Director for Environment will consider these objections and determine whether the agreed proposal should be implemented or not, and if so, with or without modification and if there are objections, those objections are dealt with in the normal way with Ward members,**

Councillor Rohit Grover MOVED the following amendment to Recommendation 6 which was SECONDED by Councillor Jennifer Grocock.

**That the Finchley and Golders Green Area Committee agree to allocate the funding of ~~£24,200~~ £25, 000 for the agreed Option (CIL from this year's CIL Area Committee budget) to design and introduce the approved Option.**

The Chairman MOVED to the vote on all three amendments. Votes were recorded as follows:

For	6
Against	0
Abstentions	0

The amendments were CARRIED and became the substantive motion.

The Chairman MOVED to the vote on the amended recommendations 2, 5 and 6, and recommendation 1,3 and 4 as set out in the report. It was unanimously RESOVLED that:

1. **That the Finchley and Golders Green Area Committee note the review of the improvements on as outlined in this report and the appendices to this report and depicted on drawings BC/001411-DESIGN-01 & BC/001411-DESIGN-02 attached as an Appendix.**
2. **Having considered both options that the Finchley and Golders Green Area Committee approve the Officer preferred Option 1 and 2 – Installation of informal crossing point, and removal of 20 metres of parking which reflects option 2 to be progressed to detailed design, as outlined in drawing BC/001411-DESIGN-01.**
3. **That the Finchley and Golders Green Area Committee delegates authority to the Strategic Director for Environment to carry out a consultation on the options in 2 above.**

4. That subject to no objections being received to the consultation, referred to in recommendation 3, the Finchley and Golders Green Area Committee delegates to the Strategic Director for Environment to implement the approved proposal.
5. That the Finchley and Golders Green Area Committee agree that if any objections are received as a result of the consultation, referred to in recommendation 3, the Strategic Director for Environment will consider these objections and determine whether the agreed proposal should be implemented or not, and if so, with or without modification and if there are objections, those objections are dealt with in the normal way with Ward members,
6. That the Finchley and Golders Green Area Committee agree to allocate the funding of £25, 000 for the agreed Option (CIL from this year's CIL Area Committee budget) to design and introduce the approved Option.

#### 14. GLENHURST ROAD, N12- FEASIBILITY STUDY

At the invitation of the Chairman, Mr. Lecordier introduced the report and noted that vertical traffic calming measures are generally not favoured in the Borough but are appropriate in certain situations.

Councillor Anne Hutton MOVED the following amendment to Recommendation 2 of the report which was SECONDED by the Chairman:

2. Having considered all three options that the Finchley and Golders Green Area Committee approve the Officer preferred Option 1 – Installation of a priority give way system on Glenhurst Road to be progressed to detailed design, as outlined in drawing BC/001348-DESIGN-01, but to remove the vertical measures

Votes were recorded as follows:

For	6
Against	0
Abstentions	0

The amendment was CARRIED and became the substantive motion.

The Committee noted that the newly amended Recommendation 2 would change the cost of the project from £20,350 to £19,000.

Councillor Anne Hutton MOVED the following amendment to Recommendation 6 in the report:

6. That the Finchley and Golders Green Area Committee agree to allocate the funding of ~~£20,350~~ £19,000 for the agreed Option (CIL from this year's CIL Area Committee budget) to design and introduce the approved Option.

Votes were recorded as follows:

For	6
Against	0
Abstentions	0

The amendment was CARRIED and became the substantive motion. The Chairman MOVED to the vote on the amended Recommendations 2 and 6, and the remaining Recommendations as set out in the report.

It was unanimously RESOLVED:

1. That the Finchley and Golders Green Area Committee note the review of the improvements on as outlined in this report and the appendices to this report and depicted on drawings BC/001348-DESIGN-01, BC/001348-DESIGN-02 & BC/001348-DESIGN-03 attached as an Appendix.
2. Having considered all three options that the Finchley and Golders Green Area Committee approve the Officer preferred Option 1 – Installation of a priority give way system on Glenhurst Road to be progressed to detailed design, as outlined in drawing BC/001348-DESIGN-01, but to remove the vertical measures.
3. That the Finchley and Golders Green Area Committee delegates authority to the Strategic Director for Environment to carry out a consultation on the preferred Option 1.
4. That subject to no objections being received to the consultation, referred to in recommendation 3, the Finchley and Golders Green Area Committee delegates the Strategic Director for Environment to implement the approved proposal.
5. That the Finchley and Golders Green Area Committee agree that if any objections are received as a result of the consultation, referred to in recommendation 3, the Strategic Director for Environment will consider these objections and determine whether the agreed proposal should be implemented or not, and if so, with or without modification.
6. That the Finchley and Golders Green Area Committee agree to allocate the funding of £19,000 for the agreed Option (CIL from this year's CIL Area Committee budget) to design and introduce the approved Option.

## **15. FORWARD WORK PROGRAMME**

The Committee considered the Forward Work Programme as set out in the report. A Member requested further information on which items would be coming to the next Committee meeting.

During the consideration of the above items, Councillor Dean Cohen left the meeting at 20:20.

**RESOLVED that the Committee note the Forward Work Programme.**

## **16. ANY ITEM(S) THE CHAIRMAN DECIDES ARE URGENT**

There were none.

The meeting finished at 20:23 pm

	AGENDA ITEM 6 <b>Finchley and Golders Green Area Committee</b>  <b>17 October 2018</b>
<b>Title</b>	<b>Referrals from Finchley and Golders Green Residents Forum</b>
<b>Report of</b>	Head of Governance
<b>Wards</b>	All
<b>Status</b>	Public
<b>Enclosures</b>	None
<b>Officer Contact Details</b>	Anita Vukomanovic <a href="mailto:anita.vukomanovic@barnet.gov.uk">anita.vukomanovic@barnet.gov.uk</a> 020 8359 7034

<b>Summary</b>
At the meeting of Finchley and Golders Green Residents Forum, 6 September 2018, one petition and one issue was referred to this Committee for consideration.

<b>Recommendation</b>
That the Area Committee considers the petition referred by the Finchley and Golders Green Residents' Forum.

**1. WHY THIS REPORT IS NEEDED**

- 1.1 The Council's Constitution permits the referral of petitions and issues to Area Committees. The following petition has been referred by the Chairman Finchley and Golders Green Residents' Forum to the Area Committee:

**Petition: Install Speed Monitoring on the Vale NW11**

**Submitted by: Nahed Sarig**

**Signatures: 26**

**Ward: Childs Hill**

1

Add speed monitoring devices on The Vale (between the Rodborough Rd roundabout until Hendon way) and a traffic sign clearly showing the speed limit. The current speed limit is 30mph but it is evident that drivers are systematically breaching this limit by a large margin and driving dangerously. This poses a risk to residents' safety, especially to children.

The Vale (from the Rodborough Rd roundabout until Hendon way) is quite busy with traffic which includes TFL buses (102 and 226 lines), HGVs and other large vehicles. The current speed limit is 30 mph but drivers are systematically breaching this limit by far and are constantly racing through The Vale. People are driving so fast that every time a car speeds through, our house shakes. The vibrations are more intense when HGVs or TFL buses race through the street. This is a big concern for our safety and that of our children. It could be even more disastrous in the event a speeding vehicle loses control and crashes through one of the houses.

We are therefore petitioning for:

- installing a traffic sign indicating the speed limit, and
- installing speed monitoring devices to assess the average speed at which vehicles pass through the street.

**2. REASON FOR REFFERAL**

2.1 The above has been referred by the Chairman Finchley and Golders Green Residents' Forum to the Area Committee.

**3. REASONS FOR RECOMMENDATIONS**

3.1 As set out above.

**4. ALTERNATIVE OPTIONS CONSIDERED AND NOT RECOMMENDED**

4.1 N/A

## **5. POST DECISION IMPLEMENTATION**

5.1 N/A

## **6. IMPLICATIONS OF DECISION**

### **6.1 Resources (Finance & Value for Money, Procurement, Staffing, IT, Property, Sustainability)**

6.1.1 None in the context of this report.

### **6.2 Legal and Constitutional References**

6.2.1 The Council's Constitution – Article 3, Residents and the Council states that Residents Forums may: *“decide that the issue be referred to the next meeting of an Area Committee for consideration, subject to the issue being within the terms of reference of an Area Committee”*

### **6.3 Risk Management**

6.3.1 None in the context of this report.

### **6.4 Equalities and Diversity**

6.4.1 None in the context of this report.

### **6.5 Consultation and Engagement**

6.5.1 Not in the context of this report.

## **7. BACKGROUND PAPERS**

7.1 None.

This page is intentionally left blank



	<p><b>Finchley &amp; Golders Green Area Committee</b></p> <p><b>17 October 2018</b></p>
<p style="text-align: right;"><b>Title</b></p>	<p><b>Area Committee Funding - Community Infrastructure Levy update</b></p>
<p style="text-align: right;"><b>Report of</b></p>	<p>Finance Manager, Commissioning Group</p>
<p style="text-align: right;"><b>Wards</b></p>	<p>Childs Hill, East Finchley, Finchley Church End, Garden Suburb, Golders Green, West Finchley, Woodhouse</p>
<p style="text-align: right;"><b>Status</b></p>	<p>Public</p>
<p style="text-align: right;"><b>Urgent</b></p>	<p>No</p>
<p style="text-align: right;"><b>Key</b></p>	<p>No</p>
<p style="text-align: right;"><b>Enclosures</b></p>	<p>Appendix 1 – Allocation of awards, spend and balance available – CIL Reserve</p>
<p style="text-align: right;"><b>Officer Contact Details</b></p>	<p>Gary Hussein, Finance Manager, Commissioning Group Contact: Gary.Hussein@barnet.gov.uk</p>

### Summary

This report is to update Members of the budget allocations for the Area Committee, to enable consideration of applications for funding during 2018/19.

### Recommendations

1. That the Finchley & Golders Green Area Committee notes the amount available for allocation during 2018/19, as set out in Appendix 1
2. That the Finchley & Golders Green Area Committee notes the amount of re-allocated underspends & overspends in Section 2.1

## **1. WHY THIS REPORT IS NEEDED**

- 1.1 This report indicates the allocation of part of the Community Infrastructure (“CIL”) to the Finchley & Golders Green Area Committee (Area Committee). This will enable the Area Committee to determine the amounts that can be allocated at this, and future meetings.
- 1.2 On 9th July 2015, the Policy & Resources Committee approved that part of the income from the CIL would be delegated to the Council’s Area Committees. Area Committees should be treated in the same way as Parish Councils and allocated at least 15% of the CIL receipts for their local area. This is to be capped at a total of £100 per dwelling in the constituency area and ring-fenced for spend on infrastructure schemes and anything else that is concerned with addressing the demands that development places on an area. If there is a neighbourhood plan or a neighbourhood order within the constituency area of the Area Committee the allocation will increase to 25% and not capped.
- 1.3 The amounts approved from the CIL reserve were based on estimates from the service department, with a view that should the estimate prove to be understated there would be no further call on the area committee budgets, without an additional approval. Expenditure exceeding 15% of the original estimate will require an explanation to enable the committee to agree any additional funding.
- 1.4 This report includes an analysis of the actual costs of the works and enables members to compare with the estimate. The net underspend on the CIL funded projects are added to the balance available where applicable.
- 1.5 Detail as to the activity to date of this Area Committee and the balance available are attached at Appendix 1 to this report.

## **2. CIL activity**

- 2.1 The latest position shows expenditure to June 2018. The total amount of underspends from 2015 – 2018 is £0.098m, whilst the total funded overspends on schemes total £0.013m.

## **3. REASONS FOR RECOMMENDATIONS**

- 3.1 Funding has been allocated to various organisations and/or projects and this will enable the Area Committee to note the amount available for future allocation.

## **4. ALTERNATIVE OPTIONS CONSIDERED AND NOT RECOMMENDED**

4.1 No alternative options were considered

## **5. POST DECISION IMPLEMENTATION**

5.1 Decisions can be made by the Area Committee to allocate funding to organisations from the Area Committee general reserves based on member supported applications and from the Area Committee CIL reserve for requests for infrastructure related surveys and works and anything else that is concerned with addressing the demands that development places on the area.

## **6. IMPLICATIONS OF DECISION**

### **6.1 Corporate Priorities and Performance**

6.1.1 The funding enables the Area Committee Budgets to contribute to the Corporate Plan's objective to promote family and community wellbeing and support engaged, cohesive and safe communities, by helping communities access the support they need to become and remain independent and resilient.

### **6.2 Resources (Finance & Value for Money, Procurement, Staffing, IT, Property, Sustainability)**

6.2.1 An annual allocation of £0.150m is made to each Area Committee. Appendix 1 shows the committee balance for 2018/19 to be £0.046m. This takes account of the amount allocated for the current year together with under and overspends relating to previous financial years.

### **6.3 Social Value**

6.3.1 Not applicable to this report

### **6.4 Legal and Constitutional References**

6.4.1 CIL is a planning charge that was introduced by the Planning Act 2008 to help deliver infrastructure to support the development in an area. It came into force on 6 April 2010 through the Community Infrastructure Levy Regulations 2010 as amended ("the Regulations").

6.4.2 Section 216 of the Planning Act 2008 lists some examples of infrastructure which CIL can fund. The Council as the Charging Authority has published a Regulation 123 List (of the Regulations) which lists infrastructure that will be funded wholly or in part by CIL.

6.4.3 Regulation 59 (f)(3) of the Regulations as amended allow the Council, as the Charging Authority to use the CIL to support the development of the relevant area by funding the provision, improvement, replacement, operation or maintenance of infrastructure or, anything else that is concerned with addressing the demands that development places on an area.

6.4.4 As a result of this, 15% of the CIL budget is allocated to the Area Committee.

6.4.5 Council Constitution, Article 7, Committees, Forums, Working Groups and

Partnerships – the terms reference of Area Committees include:

5) Determine the allocation of Community Infrastructure Levy funding within the constituency up to a maximum of £25,000 per scheme / project in each case subject to sufficient of the budget allocated to the committee being unspent

**6.5 Risk Management**

There are no risks to the Council as a direct result of this report

**6.6 Equalities and Diversity**

There are no equality and diversity issues as a direct result of this report.

**6.7 Consultation and Engagement**

There are no equality and diversity issues as a direct result of this report

**7. BACKGROUND PAPERS**

Policy & Resources Committee, 9 July 2015

<http://barnet.moderngov.co.uk/documents/s24360/Delegating%20a%20proportion%20of%20Community%20Infrastructure%20Levy%20CIL%20income%20to%20the%20Councils%20Area%20Committe.pdf>



This page is intentionally left blank

Finchley & Golders Green 2018/19	2018/19 Budget Allocation (CIL Reserve)	Actual Spend	Predicted Spend	(Underspend to be reallocated) / Above allocation	Underspend to be reallocated (Yes/No)	Original Scheme complete (Yes/No)	Amount to add back to CIL allocation	Date of Committee Approvals
Budget allocation	150,000							
Budget C/Fwd	(103,685)							
Churchfield Ave, N12, a one-way street	(3,000)	-	3,000		No	No	-	13/06/2018
Lighting of the Central Square Minyan - investigation and implementation of lighting	(5,000)	-	5,000		No	No	-	13/06/2018
Legible London signage for pedestrians around North Finchley	(5,000)	-	5,000		No	No	-	13/06/2018
Zebra crossing to connect Childs Hill Park and Basing Hill Park - initial investigations	(3,000)	-	3,000		No	No	-	13/06/2018
Assessment and Enabling Works for a Forest School at Tarling Road Open Space - meet with Greenspaces to develop a strategy	(5,000)	-	5,000		No	No	-	13/06/2018
Wheello - Funding for 10 additional e-bikes and associated items	(7,400)	7,400	-		No	Yes	-	13/06/2018
Church Lane, N2- design and introduce the approved Option	(12,100)	-	12,100		No	No	-	13/06/2018
Hampstead Way, NW11 design and introduce the approved Option	(25,000)	-	25,000		No	No	-	13/06/2018
Glenhurst Road, N12 - design and introduce the approved Option	(19,000)	-	19,000		No	No	-	13/06/2018
2015/16 Underspends returned to CIL reserve	(38,185)	7,400	77,100		-		-	
2016/17 Underspends returned to CIL reserve	46,752							
2017/18 Underspends returned to CIL reserve	14,227							
Overspends Funded	(13,130)							
New Balance	46,424							

Finchley & Golders Green 2017/18 - Outstanding Schemes	2017/18 Budget Allocation (CIL Reserve)	Actual Spend	Predicted Spend	(Underspend to be reallocated) / Above allocation	Underspend to be reallocated (Yes/No)	Original Scheme complete (Yes/No)	Amount to add back to CIL allocation	Date of Committee Approvals
	£							
Cost of tools for use by The Diggers - construction of compost bins	(5,600)	-	5,600		No	No		27/04/2017
Summers Lane - design and carry out statutory consultation and implementation	(24,200)	14,528	24,200		No	No		27/04/2017
The Hocrofts - 5 tonne weight restriction	(8,800)	2,637	8,800		No	No		27/04/2017
Granville Road - design and carry out statutory consultation and implementation	(6,500)	3,852	6,500		No	No		27/04/2017
Parking near Summerside School and Woodhouse Open Space Enhancement	(25,000)	-	25,000		No	No		02/08/2017
Village Road, N3 - feasibility study	(5,000)	1,635	5,000		No	No		02/08/2017
Friary Road Traffic Management Measures - 2 VAS signs in Friary Road, Road Markings and monitoring to take place as to the effectiveness of the implementation	(16,000)	8,804	16,000		No	No		02/08/2017
Links View - Dolis Road, N3 - Road Safety Improvements - design and carry out statutory consultation and, subject to the outcome of that consultation, introduce the agreed Option.	(20,000)	10,739	20,000		No	No		02/08/2017
New Yew tree to repair the damaged hedge at Kingsley Way junction with Meadway in the Garden Suburb	(3,000)	-	3,000		No	No		14/11/2017
Planting scheme in Gratton terrace	(9,000)	-	4,000	(5,000)	Yes	No		14/11/2017
Speed survey and on-site investigation for Glenhurst Road, N12.	(5,000)	2,094	5,000		No	No		14/11/2017
Village Road, N3 - feasibility study - Road markings and provision of two vehicle activated signs and cobbled paving sets.	(25,000)	1,579	25,000		No	No		14/11/2017
Leslie Road/Leopold Road - Request for One-Way and 20 mph	(12,650)	2,470	12,650		No	No		14/11/2017
Erskine Hill and North Square included in the controlled parking zone - design and consultation	(7,500)	-	7,500		No	No		15/02/2018
Two parts of East Finchley CPZ be split - design and consultation	(2,500)	-	2,500		No	No		15/02/2018
Speed survey on Hampstead Way between Meadway and Wellgarth Road & possibility of including controlled crossing	(5,000)	2,409	5,000		No	No		15/02/2018
Replace single yellow line outside annabel court, Hodford Road NW11 with a double yellow line	(2,000)	736	2,000		No	No		15/02/2018
Speed Control measures for Church Lane	(5,000)	1,903	5,000		No	No		15/02/2018

Finchley & Golders Green 2016/17 - Outstanding Schemes	2016/17 Budget Allocation (CIL Reserve)	Actual Spend	Predicted Spend	(Underspend to be reallocated) / Above allocation	Underspend to be reallocated (Yes/No)	Original Scheme complete (Yes/No)	Amount to add back to CIL allocation	Date of Committee Approvals
	£							
Hampstead Garden Suburb CPZ - monitor displacement before and after Garden suburb CPZ extension	(500)	3,339	3,500	3,000	No	No		30/11/2016
Buxted Road/Ashurst Road - yellow lines	(2,500)	848	2,500		No	No		16/02/2017
Friary Way/Valley Road - waiting restrictions	(4,000)	-	4,000		No	No		16/02/2017

Finchley & Golders Green 2015/16 - Outstanding Schemes	2015/16 Budget Allocation (CIL Reserve)	Actual Spend	Predicted Spend	(Underspend to be reallocated) / Above allocation	Underspend to be reallocated (Yes/No)	Original Scheme complete (Yes/No)	Amount to add back to CIL allocation	Date of Committee Approvals
	£							
Friary way parking feasibility	(5,000)	2,305	5,000		No	No		21/10/2015
Crescent road	(25,000)	5,903	25,000		No	No		13/01/2016
The Grove	(22,000)	5,292	22,000		No	No		13/01/2016
East Finchley CPZ	(10,000)	5,066	10,000		No	No		13/01/2016
Oakfield road parking (nr CPZ) - now Temple Fortune parking review	(20,000)	17,313	20,000		No	No		13/01/2016
Leslie Road CPZ feasibility study	(10,000)	9,003	10,000		No	No		30/03/2016

This page is intentionally left blank



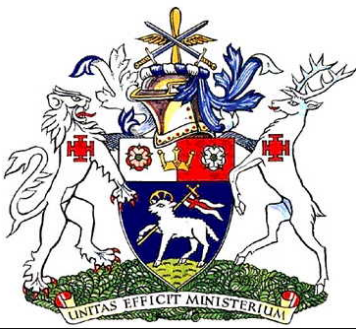

## Finchley and Golders Green Area Committee

**17 October 2018**

<b>Title</b>	<b>Member’s Item – Application for Community Infrastructure Levy (CIL) Funding</b>
<b>Report of</b>	Head of Governance
<b>Wards</b>	Garden Suburb, East Finchley, Childs Hill, West Finchley
<b>Status</b>	Public
<b>Urgent</b>	No
<b>Key</b>	No
<b>Enclosures</b>	None
<b>Officer Contact Details</b>	Anita Vukomanovic, Governance Team Leader <a href="mailto:anita.vukomanovic@barnet.gov.uk">anita.vukomanovic@barnet.gov.uk</a> 020 8359 7034

### Summary

This report informs the Area Committee the requests for CIL funding have been submitted. The Committee are requested to consider the information highlighted within this report and make a determination on its desired course of action in accordance with its powers.

### Recommendations

1. That the Area Committee consider the requests as highlighted in section 1 of the report.
2. That the Area Committee decide whether it wishes to:
  - (a) agree the requests and note the implications to the Committee’s CIL funding budget;
  - (b) defer the decision for funding for further information; or
  - (c) reject the application, giving reasons.

## 1. WHY THIS REPORT IS NEEDED

- 1.1 The following requests for funding from the Committee's allocated CIL budget have been raised:

Title	Temple Fortune Lane: Speed check breakdown
Raised by (Councillor)	John Marshall
Ward	Garden Suburb
Area Committee	Finchley and Golders Green
Member Request	<p>The Hampstead Garden Suburb Residents Association have undertaken speed checks for vehicles travelling down Temple Fortune Lane. They have advised that on the evening of 11 September 2018, they received the following results after recording speeds with a speed gun:</p> <p>Average speed recorded: <b>31.18mph</b>  Median speed: <b>31mph</b>  Proportion of vehicles recorded within 10% of speed limit : <b>78%</b>  Proportion of vehicles recorded at 30mph or below : <b>47%</b>  Proportion of vehicles recorded exceeding limit by more than 10%(ie 34mph+) : <b>22%</b>  Proportion of vehicles recorded exceeding limit by more than 20% (ie 36mph+) <b>14%</b>  Fastest speed recorded: <b>40mph (133% of speed limit) [2 cars]</b>  Number of vehicles recorded at speeds higher than limit + 10mph: <b>0</b></p> <p>Committee are asked to carry out a more comprehensive check with a view to installing VAS signs.</p>
Funding Required (£)	tbc

Title	Matters Relating to Parking and Traffic on Crewys Road, NW2
Raised by (Councillor)	Shimon Ryde
Ward	Child's Hill
Area Committee	Finchley and Golders Green

Member Request	<p>I request a review of the CPZ operating times on Crewys Road with funding made available to 1. consult residents on a change of operating hours and should this be approved 2. develop and bring about a new scheme. As part of the review, officers to consider returning the use of the business bays on Llanelly Road back to residential use since this bays are rarely occupied by business vehicles. As part of the review, Highways Officers investigate the use of restrictions and traffic calming methods to prevent the increasing use of Crewys Road as a short cut for vehicles and funded under the same request.</p> <p>By way of background, due to changes locally, mostly from developments on or close to Crewys Road, parking pressure has increased so that the current CPZ hours of operation, Zone H between 11am to noon, are no longer adequate. This parking pressure is likely to increase due to further schemes permissioned and under development locally. Residents have undertaken an informal parking survey and have the overwhelming support of residents on Crewys Road for an increase in the restricted hours similar to those of the nearby Zone C1 of 10am to 5pm. Additionally traffic movements have also changed recently and Crewys Road is now used as a short cut with traffic speeding on the road and queuing to enter Cricklewood Lane.</p> <p>I further request officers to investigate tree planting on the open area of the corner of Crewys Road and Cricklewood Lane to dissuade fly tipping which commonly occurs in this area.</p>
Funding Required (£)	tbc

Title	Barnwood Open Space East Finchley
Raised by (Councillor)	Cllr Alison Moore
Ward	East Finchley Ward
Area Committee	Finchley and Golders Green
Member Request	<b><u>Barnwood Open Space Project (East Finchley)</u></b>

**Request for funding for enabling works to open up and secure a neglected piece of woodland adjacent to the new Tarling Road Community Hub as a community resource.**

**Where and what is the Barnwood Open Space?**

This is a piece of neglected council owned open space adjacent to the new Tarling Road Hub It sits adjacent to three LSOA (Lower Super Output Areas – indicative of areas of social deprivation) areas and the Grange, Font Hills and Strawberry Vale Estates, as well as other local housing developments. It is at the heart of the Grange Big Local Lottery project area in northern part of East Finchley ward and the local profile document produced as part of the Grange Big Local ‘Local Plan’ development details that context.

[file:///C:/Users/clr.a.moore/Downloads/Grange%20Big%20Local%20community%20profile%20\(2\).pdf](file:///C:/Users/clr.a.moore/Downloads/Grange%20Big%20Local%20community%20profile%20(2).pdf)

Although identified as a potential community resource in the past (and subject to informal tree planting as part of a youth and community project in the late 1990’s), the Barnwood site had been neglected for more than 15 years and become overgrown and inaccessible to the public. With the imminent completion of the council’s new Tarling Road Community Hub, the local community has been working with the council with a view to bringing this open space back into use. Over the past decade and more the site has been fenced (although once initial clearance started, it was clear that brambles, scrub and self-seeded trees have undermined the fence in places) and has developed as a natural habitat for birds, insects etc.

The aim is to open it up as a community resource - a potential site for a local ‘forest school’ and for informal education and leisure. It would complement the facilities at the adjacent Community Hub and two more open informal play areas nearby. In the longer term there is interest in developing a Community Trust to manage the woodland and there has already been informal discussion with Long Lane Pasture Trust about their operation.

**Who has been involved and how have local community views been sought?**

Over the past few years the Grange Big Local lottery project has carried out extensive consultation within the area and evidenced local desire for better open space provision, activities and opportunities for children and young people and for community involvement. <http://www.grangebiglocal.org/>

With specific reference to the ‘Barnwood’ site, there have been active discussions between community members, partners and stakeholders involved in the Tarling Road Hub development and a successful community engagement event was held on August 5<sup>th</sup>. The ‘Explorers Picnic’ was a collaborative event involving Barnet Council, Grange Big Local, the Somali Bravanese Welfare Association, Faiths Forum 4 London, local residents and external facilitators in environmental management and education (funded by Grange Big Local). Following some initial clearance by Barnet Council and the Good Gym project, local residents attending were able to get involved with further directed clearance, bird and plant identification and blackberry picking. They were also surveyed through a detailed questionnaire about how they would like to see the resource developed and a number expressed an interest in being involved in future management of the site. The event was covered by the Archer Newspaper <http://www.the-archer.co.uk/archive.php?year=2018&month=September> and promoted via

	<p>social media.</p> <p><b>What CIL funding is being requested and why?</b>  Now that the site is being opened-up it is important that it is made physically secure to prevent vandalism and inappropriate access, and made accessible to all members of the community.  In discussion with council officers, the following works have been identified:</p> <ul style="list-style-type: none"> <li>• The existing fencing is in poor repair and needs replacing (and possible access gate upgrading).</li> <li>• There is a need for some additional professional clearance and tree works.</li> <li>• In order to make the wood fully accessible year round (for wheel chairs, buggies and visitors of a range of ages) it is proposed that the original informal paths are surfaced using natural looking Breedon (bonded) gravel such as is being planned for Windsor Open Space.</li> </ul> <p>This will improve the infrastructure of this asset and enable the site to become the good quality resource envisioned by the local community.</p> <p>It is envisaged that the woodland would then be capable of being managed by the local community, initially via the 'Adopt a Place' scheme but in the longer term, potentially, via a local Community Trust, thus ensuring that there is no ongoing revenue requirement from the council.</p> <p>Thus the CIL funding would secure and bring back into community use a currently neglected piece of local greenspace in an area of need. In doing so it would leverage local and wider funding for activities and to further development of the project (for example a suggestion from one child was to develop a 'bug hotel'), and harness input from local community volunteers. Alongside the new Community Hub, it is hoped it will contribute to supporting community cohesion and community resilience.</p> <p>The works have been assessed and would be carried out/commissioned by the council, ensuring that they are done to an appropriate standard, and are provisionally costed as follows:</p> <ul style="list-style-type: none"> <li>• Further clearance and tree works - £1500 + VAT;</li> <li>• Bonded gravel pathway (150m x 1.5m) – approx. £9000 + VAT (note that this is an estimate based on a site plan rather than detailed measurements);</li> <li>• Replacement of the chain link fencing, plus possible new/replacement gate - £2500 - £4500 + VAT;</li> <li>• <b>Total £13,000 - £15,000 + VAT</b></li> </ul> <p>The Grange Big Local Board have agreed to contribute up to £6000.  There may also be an opportunity for the council to apply to the Mayor of London Greener City Community Fund for part of the costs.</p>
<p>Funding Required (£)</p>	<p><b>Costing for the works is estimated by Greenspaces to be £13,000 to £15,000 plus VAT</b> (dependent on whether the current access gates need replacing).</p> <p>The Grange Big Local Board have agreed to contribute up to £6,000 to support</p>

	<p>the project. Therefore this application is for up to £12,000 (allowing for VAT).</p> <p>Once the site is secure and accessible, the community will be enabled to raise funding for further development and activities from a range of sources.</p>
--	---

Title	<b>Park View Road, N3</b>
Raised by (Councillor)	Ross Houston
Ward	West Finchley
Area Committee	Finchley and Golders Green
Member Request	<p>The residents of Park View Road, N3 have expressed concern about the parking situation in the road which has got considerably worse since the nearby roads were included in the local controlled parking zone (CPZ). This has made it difficult for Park View Road residents to find parking spaces in their own road as the road is now used by commercial vehicles, commuters and displaced parking from nearby roads. The road has also become congested particularly at the Park Avenue and Etchingham Park Road junctions.</p> <p>In view of a recent residents petition which was done as a result of the change in circumstances in Park View Road can residents now be consulted about a possible inclusion of their road in the CPZ.</p> <p>Many thanks</p>
Funding Required (£)	tbc

Title	<b>Gates at the entrance to the Suburb at Hampstead Way/Finchley Road junction.</b>
Raised by (Councillor)	Rohit Grover
Ward	Garden Suburb
Area Committee	Finchley and Golders Green
Member Request	<p>To address the gates at the entrance to the Suburb at Hampstead Way/Finchley Road junction. This includes broken stumps and missing or broken chains.</p>
Funding Required (£)	tbc

## 2 REASONS FOR RECOMMENDATIONS

- 1.2 As identified above Members of the Council have requested that the Committee consider requests for CIL funding. In line with guidance for Members' route to support applications for CIL funding, the Committee is asked to determine the desired course of action.
- 1.3 CIL funding can be used to fund a wide range of infrastructure (as outlined in section 216(2) of the Planning Act 2008, and regulation 59, as amended) to support the development of a local area. The Act specifically names roads and transport, flood defences, schools and education facilities, medical facilities and recreational facilities; but is not restrictive. Therefore the definition can extend to allow the levy to fund a very broad range of facilities provided they are 'infrastructure'.
- 1.4 Further examples are: play areas, parks and green spaces, cultural and sports facilities, district heating schemes, police stations and community safety facilities. The flexibility in how the funds can be applied is designed to give local areas the opportunity to choose the infrastructure they need to deliver their Local Plan.
- 1.5 Guidance states that the levy is intended to focus on the provision of new infrastructure and should not be used to remedy pre-existing deficiencies in infrastructure provision, unless those deficiencies will be made more severe by new development. Therefore if funds are intended to be used to address existing deficiencies, it is recommended that funds are used to either increase the capacity of existing infrastructure or to repair failing existing infrastructure, where it is recognised as necessary to support development in the area.
- 1.6 Guidance states that local authorities must allocate at least 15% of levy receipts to spend on priorities that should be agreed with the local community in areas where development is taking place. Therefore a decision was made to honour the provision of a 15% contribution to each of the Council's Area Committee. This is capped at £150k per committee per year.
- 1.7 Applications relating to requests should be made to this Area Committee via Members' Items as outlined in the Council's Constitution. In line with guidance, applications submitted by Members should receive an initial assessment by an appropriate Officer, and should be accompanied by a recommendation (i.e. that the Committee should support or refuse the application).
- 1.8 Members should note that the committee has the power to discharge CIL-related environmental infrastructure projects and therefore has joint budget responsibility across the Area Committees which can be spent in 2018/19. Furthermore it is noted that any request can be considered only by this Committee if it is in line with its terms of reference as contained in the Council's Constitution.

## **2. ALTERNATIVE OPTIONS CONSIDERED AND NOT RECOMMENDED**

- 2.1 Not applicable.

### **3. POST DECISION IMPLEMENTATION**

- 3.1 Post decision implementation depends on the decision taken by the Committee, and the assessing officer's recommendation.

### **4. IMPLICATIONS OF DECISION**

#### **4.1 Resources (Finance & Value for Money, Procurement, Staffing, IT, Property, Sustainability)**

- 4.1.1 The Committee has an allocated budget for Barnet Community Infrastructure Levy (CIL) from which it can award funds to Area Committee grant applications. Any allocation of funds will be assessed by Officers.

- 4.1.2 The Committee is able to award funding of up to £25,000 per project for CIL Funding. Requests for funding must be in line with the Council's priorities which are outlined in the Corporate Plan 2015 – 2020.

#### **4.2 Social Value**

- 4.2.1 Requests for CIL funding provide an avenue for Members to give consideration to funding requests which may have added social value.

#### **4.3 Legal and Constitutional References**

- 5.3.1 Council Constitution, Article 7 contains the responsibilities of the Area Committees, which includes to: "Determine the allocation of Community Infrastructure Levy funding within the constituency up to a maximum of £25,000 per scheme / project in each case subject to sufficient of the budget allocated to the committee being unspent."

#### **4.4 Risk Management**

- 4.4.1 None in the context of this report.

#### **4.5 Equalities and Diversity**

- 4.5.1 Requests for Funding allow Members of a Committee to bring a wide range of issues to the attention of a Committee in accordance with the Council's Constitution. All of these issues must be considered for their equalities and diversity implications.

#### **4.6 Consultation and Engagement**

- 4.6.1 None in the context of this report.

### **5. BACKGROUND PAPERS**

- 5.1 Meeting of the Community Leadership Committee 8 March 2016 Area Committee Funding – Savings from non- Community Infrastructure Levy (CIL) budgets: <http://barnet.moderngov.co.uk/documents/s38413/Area%20Committee%20Funding%20Savings%20from%20non-%20Community%20Infrastructure%20Levy%20CIL%20budgets.pdf>

- 5.2 Review of Area Committees – operations and delegated budgets (24 June 2015): <https://barnet.moderngov.co.uk/documents/s24009/Area%20Committees%20%20Co>



[mmunity%20Leadership%20Committee%2025%20June%202015%20-%20FINAL.pdf](#)

This page is intentionally left blank

	<p><b>Finchley and Golders Green Area Committee</b></p> <p><b>17 October 2018</b></p>
<p style="text-align: right;"><b>Title</b></p>	<p><b>Alexandra Grove/Ballards Lane, N12 Junction – Pedestrian Improvements</b></p>
<p style="text-align: right;"><b>Report of</b></p>	<p>Strategic Director for Environment</p>
<p style="text-align: right;"><b>Wards</b></p>	<p>West Finchley</p>
<p style="text-align: right;"><b>Status</b></p>	<p>Public</p>
<p style="text-align: right;"><b>Urgent</b></p>	<p>No</p>
<p style="text-align: right;"><b>Key</b></p>	<p>No</p>
<p style="text-align: right;"><b>Enclosures</b></p>	<p>Appendix 1 - Drawing No. BC/001143-15-17_FS_100-01 Appendix 2 –Tracking 2-June 2018</p>
<p style="text-align: right;"><b>Officer Contact Details</b></p>	<p>Jamie Blake – Strategic Director for Environment <a href="mailto:Jamie.blake@barnet.gov.uk">Jamie.blake@barnet.gov.uk</a></p>

### Summary

This report details the outcome of the revised safety review of pedestrian improvements on Alexandra Grove junction with Ballards Lane and including Moss Hall Crescent. (N12).

### Recommendations

1. That the Finchley and Golders Green Area Committee note the review of the Alexandra Grove/Ballard’s Lane pedestrian safety improvement as outlined in this report and the appendices to this report containing details of design proposals and safety investigations.
2. That the Finchley and Golders Green Area Committee agrees to implement recommended Scheme as shown on the drawing in Appendix 1.
3. That the Finchley and Golders Green Area Committee notes that the cost of the scheme is estimated at £52,000 which is over the Area Committee limit of £25,000.

4. That the Finchley and Golders Green Area Committee notes that the scheme will be added to the 2019/20 Local Implementation Plan (LIP) work programme for consideration for funding, subject to meeting the qualifying criteria of the traffic schemes priority tool.
5. That if the Finchley and Golders Green Area Committee decide not to progress with the scheme in this report, no further action will be taken at this location.

## 1. WHY THIS REPORT IS NEEDED

- 1.1 This report is needed to address the concerns highlighted for pedestrians crossing Alexandra Grove, close to the junction with Ballards Lane, N12.
- 1.2 A petition was reported to the 6 July 2016 Finchley and Golders Green Area Committee with 43 signatories. *'Put a zebra crossing at the top of Alexandra Grove N12 and corner of Ballards Lane'*.
- 1.3 The Finchley and Golders Green Area Committee unanimously agreed and it was therefore RESOLVED:  
'That the Committee agrees the expenditure of £5,000 from the Area Committee budget for a feasibility study to be carried out for a pedestrian crossing on Alexandra Grove N12 near its junction with Ballards Lane. A report would come back to the Committee with the available options for Alexandra Grove.'
- 1.4 Site visits have been undertaken and the following noted:
  - High incidence of pedestrian movement on Ballards Lane crossing at Alexandra Grove;
  - High traffic volumes on Alexandra Grove turning left or right into Ballards Lane;
  - Visibility issues with mature tree on Alexandra Road making it impractical to install a zebra crossing;
  - Alexandra Grove is a bus route.
- 1.5 Pedestrian crossing counts were carried out on Thursday 15 December and Saturday 17 December 2016 which indicate where the majority of pedestrians are crossing. A manual classified traffic count was also carried out on Saturday 17 December 2016.
- 1.6 The Personal Injury Accident Data has been analysed and between 1 September 2011 and 31 August 2016 five accidents occurred on Ballards Lane near its junction with Alexandra Grove. Four involved a powered two wheeler and one involved a pedestrian. All were slight, and occurred during daylight hours and in dry conditions.

- 1.7 The initial investigations and the site visits indicated that overall it would benefit pedestrians to install a pedestrian facility in this location. However, the layout of the junction with the access to Moss Hall Crescent being in close proximity to the junction with Ballards Lane makes it difficult to propose a zebra crossing point where the majority of pedestrians were shown to cross.
- 1.8 A proposal for installing a zebra crossing further west along Alexandra Grove was also investigated, however, not only was it even further from the desire line for pedestrians to cross, the location was obstructed by a very high-profile tree and existing vehicle crossing points.
- 1.9 Therefore, the feasibility indicated that it would benefit both pedestrians and all forms of transport if an uncontrolled pedestrian crossing point complete with dropped kerb and tactile paving, was installed. A kerb build-out on the west side of Moss Hall Crescent incorporated into the design will narrow the junction mouth at its junction with Alexandra Grove and help to facilitate the crossing
- 1.10 The location of the proposed island would still allow access for the 221 Bus which serves Alexandra Grove from Ballards Lane.
- 1.11 The proposal for the island was reported to the Finchley and Golders Green Area Committee on 27 April 2017 where the Committee approved the scheme and resolved, *'To allocate the funding of £13,500 from this year's CIL Area Committee budget to design and carry out statutory consultation and, subject to the outcome of that consultation, introduce the approved scheme.'*
- 1.12 However, further detailed design on the scheme and investigations and computer-generated vehicle tracking results indicated that large 5 or 6-axle lorries would be unable to turn into Alexandra Grove if a pedestrian island crossing point were to be constructed. (Appendix 2). Consideration was given to the impact this restriction to access would have and alternative routes were investigated, but these have proved unviable for large vehicles. As a result, we are unable to implement the island as proposed.

### ***Feasibility Design Proposals-Phase 2***

- 1.13 Therefore, alternative options have been explored and a revised proposed layout which includes the construction of a raised junction entry treatment with a buildout on the west side of Moss Hall Crescent to narrow the junction mouth on Alexandra Grove but still permit large vehicles access. Which is shown on Drawing BC/001143-15-17-FS\_100\_01.
- 1.14 The proposed kerb buildout at Moss Hall Crescent junction with Alexandra Grove will incorporate tactile paving, dropped kerbs and safety bollards. An increase of 5.5 metres to the existing double-yellow lines as indicated on the drawing, to improve visibility for all users.
- 1.15 The proposals also include:
- Repositioning the existing lamp column to back of footway on Alexandra Grove.
  - Repositioning existing 'Give Way' sign and post on Alexandra Grove.

- Tactile paving, dropped kerbs and safety bollards will also be incorporated at the raised junction entry treatment to facilitate ease of crossing for all users.

1.16 The committee should consider that vertical traffic calming measures are generally not favoured in the Borough but are appropriate in certain situations. This was confirmed in a report on Traffic Calming to the Environment Committee on 14 July 2016. The Environment Committee, having considered the report on Vertical Traffic Calming measures, resolved:

*‘That the Environment Committee noted the current approach to Traffic Calming Measures as set out in this report. That the Environment Committee approved the following Policy Wording:*

*‘Generally, this Council opposes the use of vertical traffic calming measures, but acknowledges that vertical traffic calming measures can sometimes be appropriate. Officers should not, though, propose these apart from in exceptional circumstances and with all such decisions reserved for Members, and that Members be consulted with from the earliest opportunity, if required’.*

1.17 Ward Councillors have been consulted on the introduction of vertical measures and no comments have been received at time of publication.

## **1 REASONS FOR RECOMMENDATIONS**

2.1 The proposals are recommended to make crossing Alexandra Grove at its junction with Ballard Lane safer and make the area a more attractive environment for local residents and schools. It would also improve local shopping facilities for those who make use of the pedestrian footways.

## **3 ALTERNATIVE OPTIONS CONSIDERED AND NOT RECOMMENDED**

3.1 Consideration was given to making Moss Hall Crescent a ‘no through’ road and providing a zebra crossing at its junction with Alexandra Grove. This location would not have been within pedestrian desire lines and therefore the crossing was less likely to be used with pedestrians still crossing closer to Ballards Lane where the proposed traffic island was to be located.

3.2 Consideration was also given to a zebra crossing on Alexandra Grove but because of visibility issues, i.e. a very high profile tree on Alexandra Grove which would have to be removed, the option was rejected. Siting the zebra crossing here would have been even further west and would not have been within pedestrian desire lines and therefore the crossing was less likely to be used with pedestrians still crossing closer to Ballards Lane where the proposed traffic island was to be located.

3.3 The only other option at this stage is to not proceed with any of the proposed improvements. This will however not address the original concern raised by local residents.

## **4 POST DECISION IMPLEMENTATION**

**4.1** If the report's recommendation is approved, the scheme would be added to the 2019/20 Local Implementation Plan (LIP) work programme for consideration for funding, subject to meeting the qualifying criteria of the traffic schemes priority tool.

## **5 IMPLICATIONS OF DECISION**

### **5.1 Corporate Priorities and Performance**

5.1.1 The proposals here will particularly help to address the Corporate Plan delivery objectives of “a clean and attractive environment, with well-maintained roads and pavements, flowing traffic” and “a responsible approach to regeneration, with thousands of new homes built” by helping residents to feel confident moving around their local area on foot, and in a vehicle and contribute to reduced congestion.

5.1.2 The proposals also help create an environment that encourages an active lifestyle and reduces obesity by promoting walking and other sustainable modes of travel thus helping to deliver active travel opportunities as identified in the Health and Wellbeing Strategy for children and the population generally.

5.1.3 The scheme will also impact on the health and wellbeing needs of the local population as identified in Barnet's Joint Strategic Needs Assessment.

### **5.2 Resources (Finance & Value for Money, Procurement, Staffing, IT, Property, Sustainability)**

5.2.1 Council funding of £5,000 was agreed from the Finchley and Golders Green Area Budget to carry out the initial review of Alexandra Grove, preliminary design and layout proposals.

5.2.2 Council funding of £13,500 was agreed from the Finchley and Golders Green Area Budget to carry out the detailed design and implementation of the proposed island on Alexandra Grove.

5.2.3 The estimated implementation cost for the raised table scheme is £52,000 (based on prices contained in Year 2, Volume 4 Adjusted Rates – London Highways Alliance Contract (LoHAC) Northwest1). There is currently no allocation of funds for this scheme.

5.2.4 Once funded the work will be carried out under the existing PFI and LoHAC term maintenance contractual arrangements.

### **5.3 Social Value**

5.3.1 None in the context of this report.

## 5.4 Legal and Constitutional References

- 5.4.1 The Highways Act 1980 provides general and specific powers for the highway authority to make changes or improvements to the highway.
- 5.4.2 The Council has the necessary legal powers to introduce traffic orders to put the proposal into effect under the Road Traffic Regulation Act 1994.
- 5.4.3 Section 16 of the Traffic Management Act 2004 places obligations on traffic authorities to ensure the expeditious movement of traffic on their road network. Authorities are required to make arrangements as they consider appropriate for planning and carrying out the action to be taken in performing the duty.
- 5.4.4 The Councils Constitution, in Article 7, states that the Area Committees: "In relation to the area covered have responsibility for all constituency specific matters relating to the street scene including parking, road safety, transport, allotments and parks and trees."

## 5.5 Risk Management

- 5.5.1 None in the context of this report. Risk management may be required for work resulting from this report.

## 5.6 Equalities and Diversity

- 5.6.1 The 2010 Equality Act outlines the provisions of the Public Sector Equalities Duty which requires Public Bodies **to have due regard** to the need to:
- Eliminate unlawful discrimination, harassment and victimisation and other conduct prohibited by the Equality Act 2010
  - Advance equality of opportunity between those with protected characteristics and those without;
    - Foster good relations between persons with a relevant protected characteristic and those without.
    - The broader purpose of this duty is to integrate considerations of equality into day business and keep them under review in decision making, the design of policies and the delivery of services
    - Introduction of the measures outlined in the report would benefit pedestrians and non-motorised traffic generally, but in particular children travelling to and from school and those escorting them.
- 5.6.2 The proposal in this report are not expected to disproportionately disadvantage individual members of the community.

## 5.7 Consultation and Engagement

- 5.7.1 A statutory consultation will be carried out in relation to the scheme proposals once funding has been agreed.

## 5.8 Insight

- 5.8.1 None in relation to this report.



## **6 BACKGROUND PAPERS**

- 6.1 6 July 2016 Finchley and Golders Green Area Committee Item 8.  
<https://barnet.moderngov.co.uk/documents/g8749/Printed%20minutes%2006th-Jul-2016%2019.00%20Finchley%20Golders%20Green%20Area%20Committee.pdf?T=1>
  
- 6.2 27 April 2017 Finchley and Golders Green Committee Item 18.  
<https://barnet.moderngov.co.uk/documents/s39359/Alexandra%20Grove%20Pedestrian%20Improvements.pdf>

# Appendix 1

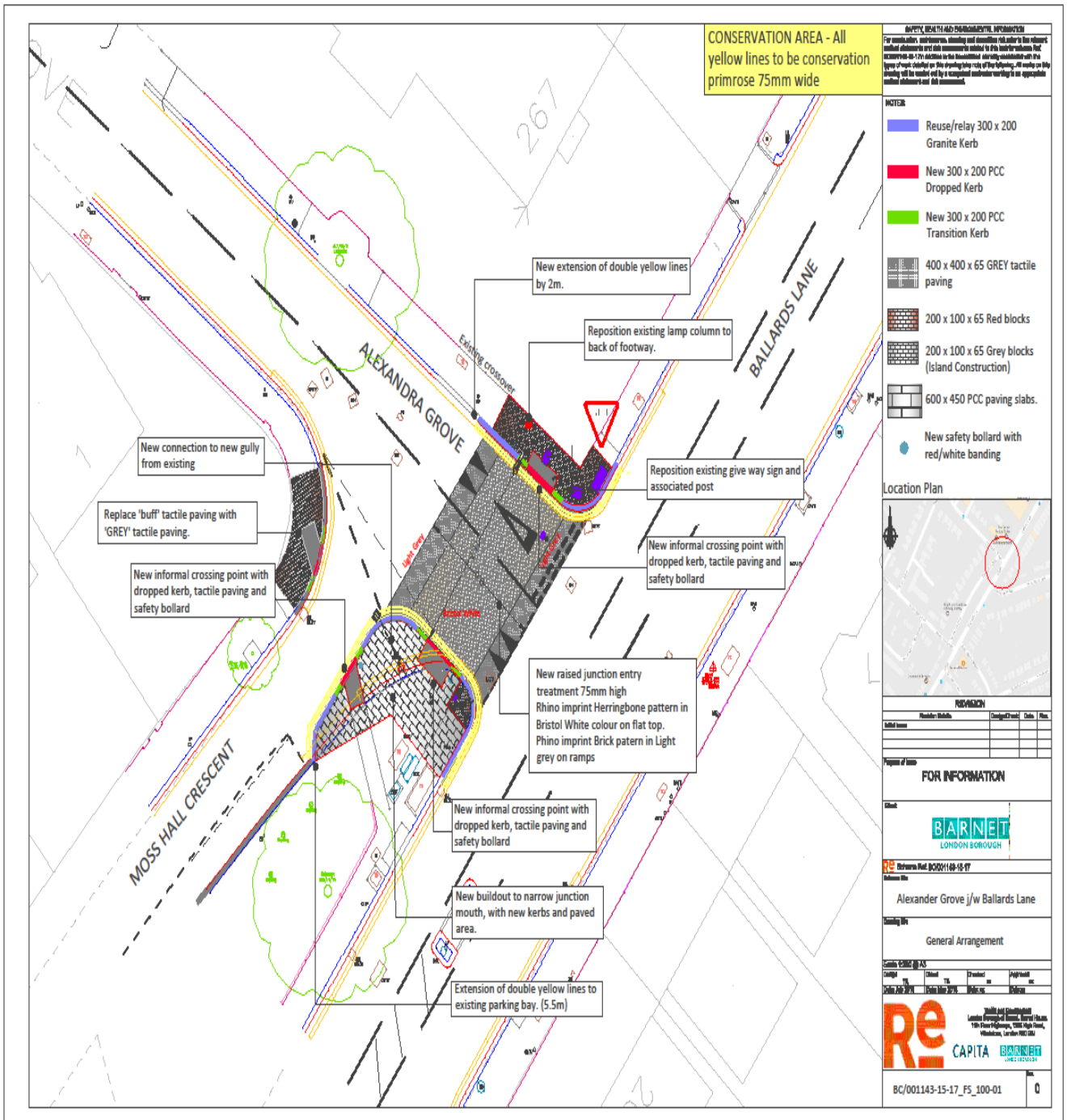



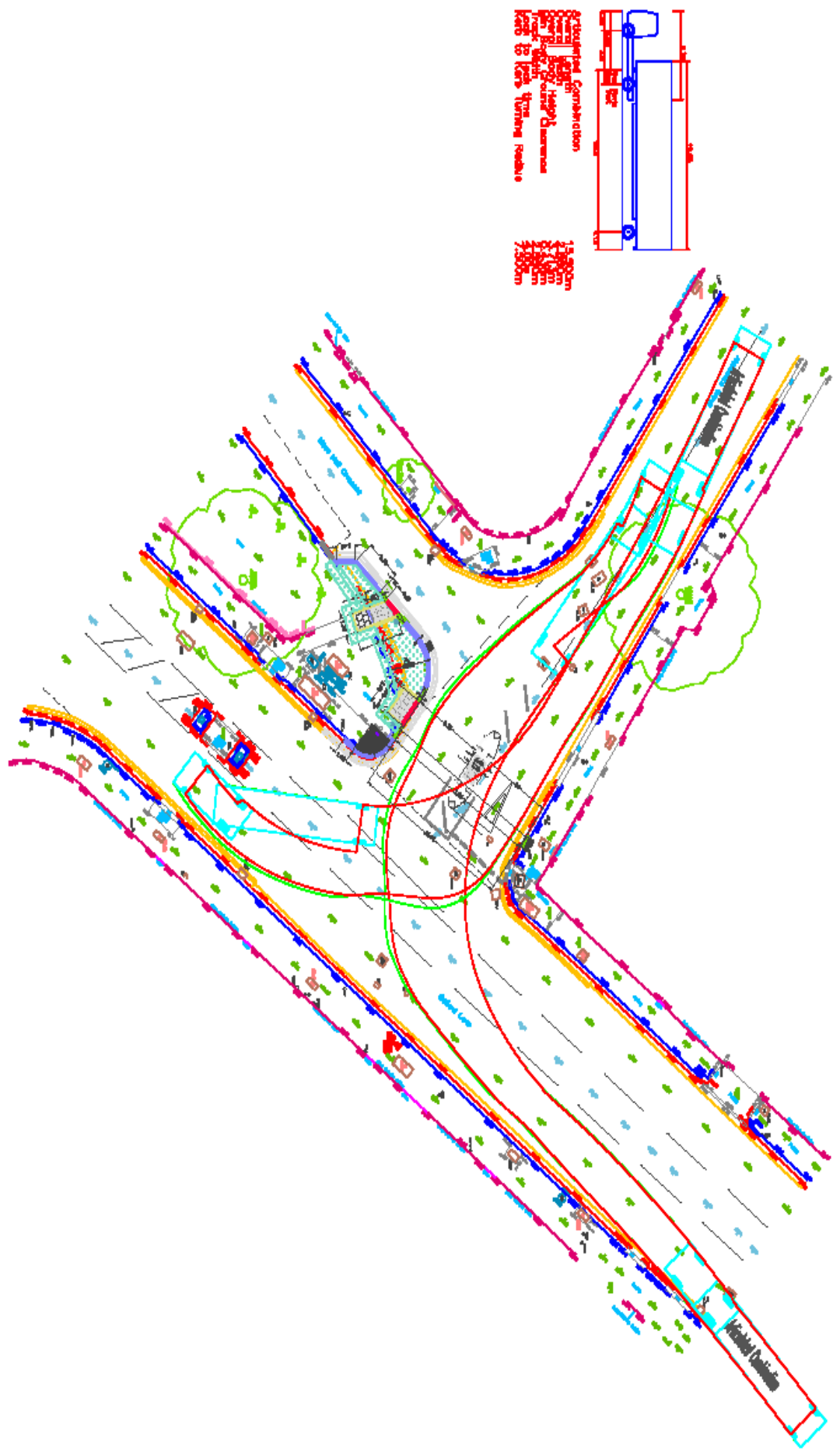

Architectural Combination  
 General Length  
 General Width  
 General Height  
 General Area  
 General Volume  
 General Weight  
 General Color  
 General Material  
 General Finish  
 General Texture  
 General Shape  
 General Form  
 General Style  
 General Function  
 General Use  
 General Location  
 General Orientation  
 General Context  
 General Environment  
 General Climate  
 General Topography  
 General Geology  
 General Hydrology  
 General Ecology  
 General Socioeconomics  
 General Culture  
 General History  
 General Future  
 General Sustainability  
 General Resilience  
 General Adaptability  
 General Innovation  
 General Creativity  
 General Collaboration  
 General Communication  
 General Transparency  
 General Accountability  
 General Integrity  
 General Honesty  
 General Respect  
 General Compassion  
 General Empathy  
 General Kindness  
 General Generosity  
 General Gratitude  
 General Patience  
 General Humility  
 General Modesty  
 General Simplicity  
 General Clarity  
 General Focus  
 General Discipline  
 General Diligence  
 General Perseverance  
 General Determination  
 General Courage  
 General Bravery  
 General Strength  
 General Resilience  
 General Flexibility  
 General Openness  
 General Curiosity  
 General Learning  
 General Growth  
 General Progress  
 General Success  
 General Achievement  
 General Fulfillment  
 General Well-being  
 General Happiness  
 General Peace  
 General Harmony  
 General Balance  
 General Health  
 General Wealth  
 General Power  
 General Influence  
 General Leadership  
 General Service  
 General Contribution  
 General Legacy  
 General Impact  
 General Change  
 General Transformation  
 General Evolution  
 General Revolution  
 General Innovation  
 General Creativity  
 General Collaboration  
 General Communication  
 General Transparency  
 General Accountability  
 General Integrity  
 General Honesty  
 General Respect  
 General Compassion  
 General Empathy  
 General Kindness  
 General Generosity  
 General Gratitude  
 General Patience  
 General Humility  
 General Modesty  
 General Simplicity  
 General Clarity  
 General Focus  
 General Discipline  
 General Diligence  
 General Perseverance  
 General Determination  
 General Courage  
 General Bravery  
 General Strength  
 General Resilience  
 General Flexibility  
 General Openness  
 General Curiosity  
 General Learning  
 General Growth  
 General Progress  
 General Success  
 General Achievement  
 General Fulfillment  
 General Well-being  
 General Happiness  
 General Peace  
 General Harmony  
 General Balance  
 General Health  
 General Wealth  
 General Power  
 General Influence  
 General Leadership  
 General Service  
 General Contribution  
 General Legacy  
 General Impact  
 General Change  
 General Transformation  
 General Evolution  
 General Revolution



This page is intentionally left blank

	<p><b>Finchley and Golders Green Area Committee</b></p> <p><b>17 October 2018</b></p>
<p style="text-align: right;"><b>Title</b></p>	<p><b>The Vale junction with Granville Road and Wayside, NW11</b></p>
<p style="text-align: right;"><b>Report of</b></p>	<p>Strategic Director for Environment</p>
<p style="text-align: right;"><b>Wards</b></p>	<p>Childs Hill</p>
<p style="text-align: right;"><b>Status</b></p>	<p>Public</p>
<p style="text-align: right;"><b>Urgent</b></p>	<p>No</p>
<p style="text-align: right;"><b>Key</b></p>	<p>No</p>
<p style="text-align: right;"><b>Enclosures</b></p>	<p>Appendix 1 - Drawing No. BC/001495_03_FS_100-01 Appendix 2 –Tracking</p>
<p style="text-align: right;"><b>Officer Contact Details</b></p>	<p>Jamie Blake – Strategic Director for Environment <a href="mailto:Jamie.blake@barnet.gov.uk">Jamie.blake@barnet.gov.uk</a></p>

<h2>Summary</h2>
<p>This report details the outcome a feasibility study to determine the viability of a zebra crossing on The Vale as a safer means for pedestrians wishing to cross to and from Basing Hill Park and Childs Hill Park.</p>

<h2>Officers Recommendations</h2>
<ol style="list-style-type: none"> <li>1. That the Finchley and Golders Green Area Committee note the review of The Vale pedestrian safety improvement as outlined in this report and the appendices to this report containing details of design proposals and safety investigations.</li> <li>2. That the Finchley and Golders Green Area Committee agrees to implement the pedestrian safety scheme on The Vale NW11, as set out in this report and detailed in Appendix 1 and 2.</li> </ol>

3. That the Finchley and Golders Green Area Committee notes that the cost of the scheme is estimated at £35,000 which is over the Area Committee limit of £25,000.

4. That the Finchley and Golders Green Area Committee notes that the scheme will be added to the 2019/20 Local Implementation Plan (LIP) work programme for consideration for funding, subject to meeting the qualifying criteria of the traffic schemes priority tool.

5. That if the Finchley and Golders Green Area Committee decide not to progress with the scheme in this report, no further action will be taken at this location.

## 1. WHY THIS REPORT IS NEEDED

1.1 This report is needed to address the concerns highlighted for pedestrians crossing The Vale close to the junctions with Granville Road and Wayside NW11.

1.2 A Members item in the name of Councillor Arjun Mitra was raised at the Finchley and Golders Green Area Committee on 13 June 2018.

1.3 Residents of Granville Road Estate have requested a zebra crossing over The Vale to connect Childs Hill Park and Basing Hill Park. A zebra crossing would enable safer and wider access to both parks.

1.4 The Finchley and Golders Green Area Committee unanimously agreed and it was therefore **RESOLVED** on 13 June 2018:

*‘That the Committee agrees the expenditure of £3,000 from the Area Committee budget for a feasibility study to be carried out for a zebra crossing on The Vale NW11 near its junction with Granville Road and Wayside. A report would come back to the Committee with the available options for The Vale.’*

1.5 A site visit was undertaken and the following noted:

- Very few incidences of pedestrians crossing the road. (However, note the site visit was conducted outside term time;
- Reasonable volume of free-flowing traffic, but speeds and volumes may have been affected by utility works on The Vale;
- The only place where a zebra crossing may be situated would entail the removal of an existing Parking bay. (Residents permit holders Zone ‘H’ Mon-Fri 11am – 12pm);
- The Vale is a bus route, serving route numbers 102 and 226.

1.6 Speed and volume counts were carried out 24 September to 1 October 2018 in two locations for 7 days, 24 hours per day.



- 1.7 The Personal Injury Accident Data for five years has been analysed between 1 January 2013 and 31 December 2017. Three accidents occurred on The Vale near its junction with Wayside. One involved a powered two-wheeler and two involved cars. All were slight, two occurred during day light hours and in dry conditions, one occurred during the hours of darkness and in wet conditions.
- 1.8 The initial investigation and the site visit indicated that overall it would benefit pedestrians to install a pedestrian facility in this location. However, the layout of the junction would necessitate the removal of a parking bay to aid visibility issues.
- 1.9 A proposal for installing an informal island crossing point was also considered, however, computer-generated vehicle tracking results indicated that large vehicles such as refuse vehicles turning into Wayside could not make the turn without over-running the island. Please refer to **Appendix 2**.
- 1.10 Therefore, the feasibility indicated that it would benefit both pedestrians and all forms of transport if a zebra crossing was installed at this location.

### ***Feasibility Design Proposals***

- 1.11 Drawing BC/001495\_03\_FS\_100-01 shows the proposed layout which includes the construction of a zebra crossing complete with dropped kerb and tactile paving.
- 1.12 The proposals will have no negative impact on existing vehicle crossovers.
- 1.13 The proposals also include the repositioning of the Residents' Permit parking bay east of the junction with Wayside.

## **2 REASONS FOR RECOMMENDATIONS**

- 2.1 The proposals are recommended to improve safety and make crossing The Vale at its junctions with Wayside and Granville Road safer and a more attractive environment for local residents, schools and local shopping facilities for those who make use of the pedestrian footways and as a direct link between Basing Hill Park and Childs Hill Park.

## **3 ALTERNATIVE OPTIONS CONSIDERED AND NOT RECOMMENDED**

- 3.1 The installation of an island was considered but not progressed due to the reasons outlined above.
- 3.2 The only other option at this stage is to not proceed with any of the proposed improvements. This will however not address the original concern raised by local residents.

## **4 POST DECISION IMPLEMENTATION**

- 4.1 If the reports recommendation is approved, the scheme would be added to the to the 2019/20 Local Implementation Plan (LIP) work programme for consideration for the funding, subject to meeting the qualifying criteria of the traffic schemes priority tool.

## **5 IMPLICATIONS OF DECISION**

### **5.1 Corporate Priorities and Performance**

- 5.1.1 The proposals here will particularly help to address the Corporate Plan delivery objectives of “a clean and attractive environment, with well-maintained roads and pavements, flowing traffic” and “a responsible approach to regeneration, with thousands of new homes built” by helping residents to feel confident moving around their local area on foot, and in a vehicle and contribute to reduced congestion.

- 5.1.2 The proposals also help create an environment that encourages an active lifestyle and reduces obesity by promoting walking and other sustainable modes of travel thus helping to deliver active travel opportunities as identified in the Health and Wellbeing Strategy for children and the population generally

- 5.1.3 The scheme will also impact on the health and wellbeing needs of the local population as identified in Barnet’s Joint Strategic Needs Assessment.

### **5.2 Resources (Finance & Value for Money, Procurement, Staffing, IT, Property, Sustainability)**

- 5.2.1 Council funding of £3,000 was agreed from the Finchley and Golders Green Area Budget to carry out the initial review of The Vale, preliminary design and layout proposals.

- 5.2.2 The estimated implementation cost for the recommendations is £35,000 (based on prices contained in Year 2, Volume 4 Adjusted Rates – London Highways Alliance Contract (LoHAC) Northwest1). There is currently no allocation of funds for this scheme.

- 5.2.3 The work will be carried out under the existing PFI and LoHAC term maintenance contractual arrangements.

### **5.3 Social Value**

- 5.3.1 None in the context of this report.

### **5.4 Legal and Constitutional References**

- 5.4.1 The Highways Act 1980 provides general and specific powers for the highway authority to make changes or improvements to the highway.

5.4.2 The Council has the necessary legal powers to introduce traffic orders to put the proposal into effect under the Road Traffic Regulation Act 1994.

5.4.3 Section 16 of the Traffic Management Act 2004 places obligations on traffic authorities to ensure the expeditious movement of traffic on their road network. Authorities are required to make arrangements as they consider appropriate for planning and carrying out the action to be taken in performing the duty.

5.4.4 The Councils Constitution, in Article 7, states that the Area Committees: "In relation to the area covered have responsibility for all constituency specific matters relating to the street scene including parking, road safety, transport, allotments and parks and trees."

## **5.5 Risk Management**

5.5.1 None in the context of this report. Risk management may be required for work resulting from this report.

## **5.6 Equalities and Diversity**

5.6.1 The 2010 Equality Act outlines the provisions of the Public Sector Equalities Duty which requires Public Bodies **to have due regard** to the need to:

- Eliminate unlawful discrimination, harassment and victimisation and other conduct prohibited by the Equality Act 2010
- Advance equality of opportunity between those with protected characteristics and those without;
  - Foster good relations between persons with a relevant protected characteristic and those without.
  - The broader purpose of this duty is to integrate considerations of equality into day business and keep them under review in decision making, the design of policies and the delivery of services
  - Introduction of the measures outlined in the report would benefit pedestrians and non-motorised traffic generally, but in particular children travelling to and from school and those escorting them.

5.6.2 The proposal in this report are not expected to disproportionately disadvantage individual members of the community.

## **5.7 Consultation and Engagement**

5.7.1

A statutory consultation will be carried out in relation to the scheme proposals once funding has been agreed.

## **5.8 Insight**

5.8.1 None in relation to this report.

## **6 BACKGROUND PAPERS**

### **6.1**

13 June 2018 Finchley and Golders Green Area Committee Members Item in the name of Cllr Arjun Mittra.

<http://barnet.moderngov.co.uk/ieListDocuments.aspx?CId=712&MId=9524&V>

# Appendix 1

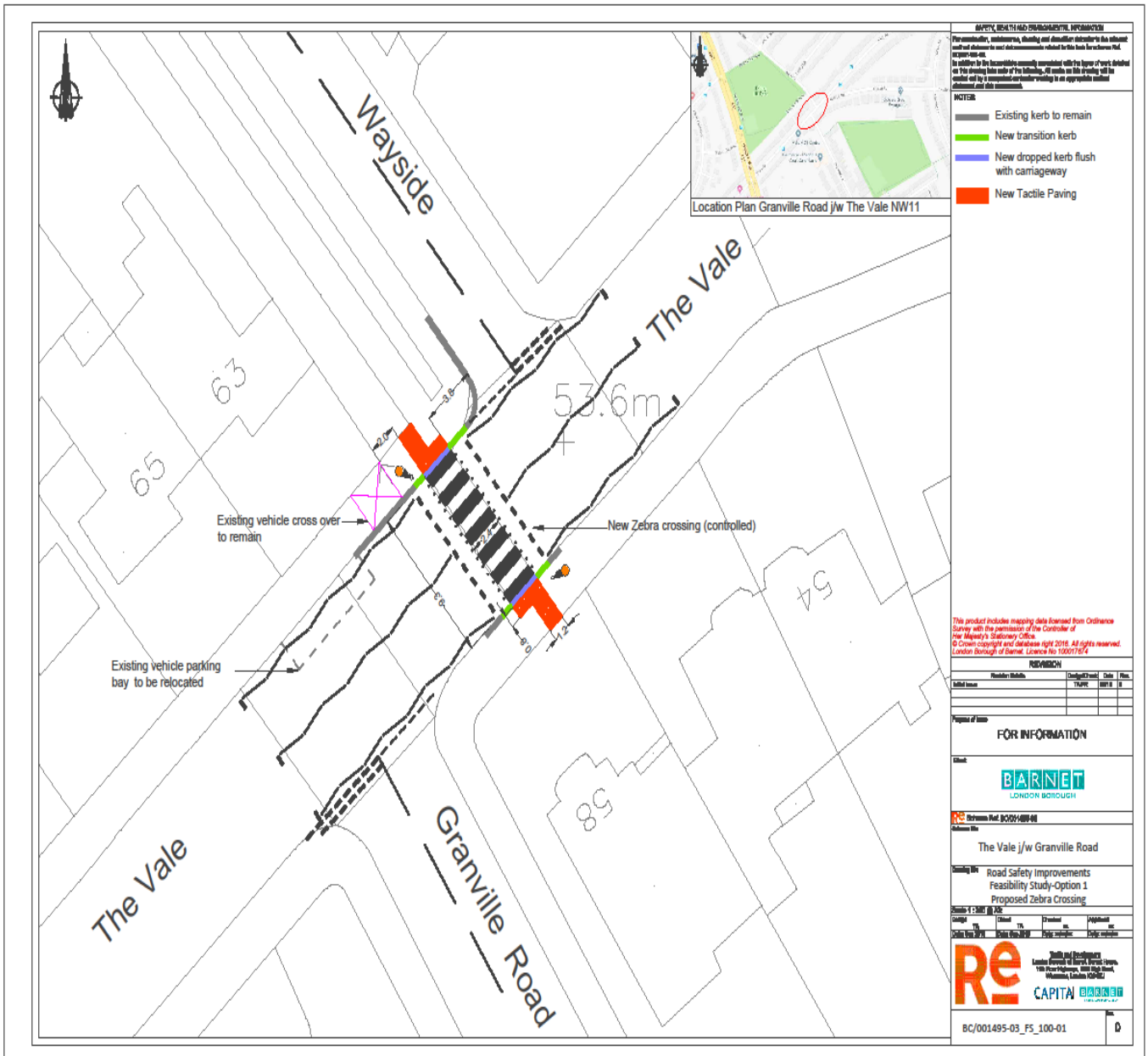

# Appendix 2

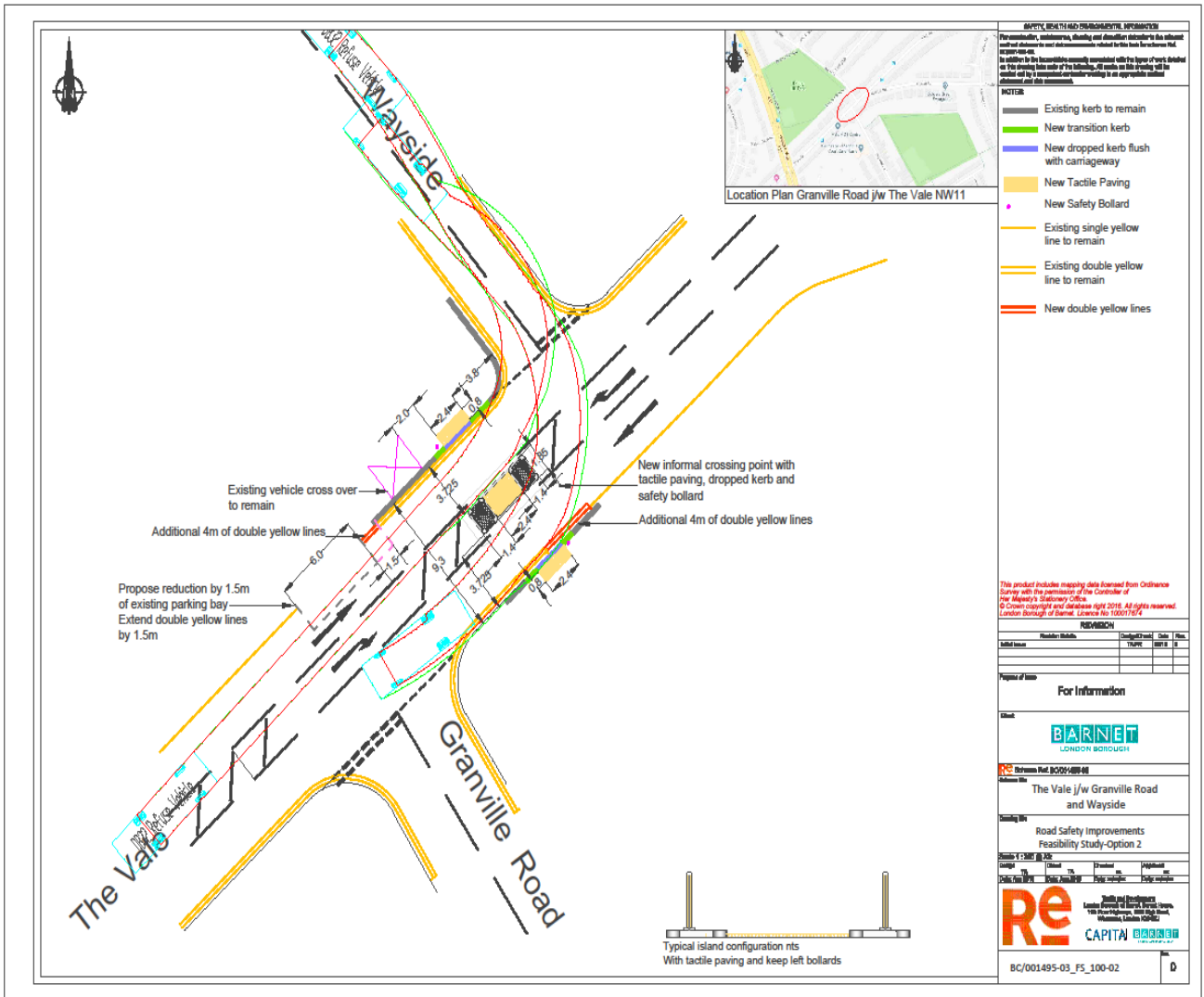

**London Borough of Barnet  
Finchley & Golders Green Area  
Committee Work Programme  
October 2018 – April 2019**

Contact: Anita Vukomanovic 020 8359 7034 [anita.vukomanovic@barnet.gov.uk](mailto:anita.vukomanovic@barnet.gov.uk)

Title of Report	Overview of decision	Report Of ( <i>officer</i> )	Issue Type (Non key/Key/Urgent)
<b>17 October 2018</b>			
Alexandra Grove/Ballards Lane, N12 Junction – Pedestrian Improvements	Report to detail Alexandra Grove/Ballards Lane, N12 Junction – Pedestrian Improvements	Strategic Director for Environment	Non-key
Somerton Road NW2 – Width restriction - Feasibility Study	Report to detail Somerton Road NW2 – Width restriction - Feasibility Study	Strategic Director for Environment	Non-key
The Vale junction with Granville Road and Wayside, NW11	Report to detail The Vale junction with Granville Road and Wayside, NW11	Strategic Director for Environment	Non-key
<b>Items to be Allocated</b>			
Parking on/around Station Road, Station Close, Lichfield Grove, Dollis Park and any other relevant roads	At the 16th February 2017 meeting of the committee, it was agreed that the Commissioning Director, Environment, would prepare a report to a future meeting of the Committee to consider the issues raised on Station Road, Station Close, Lichfield Grove, Dollis Park and any other relevant roads, with a recommended course of action	Strategic Director of Environment	Non-key



<b>Title of Report</b>	<b>Overview of decision</b>	<b>Report Of (<i>officer</i>)</b>	<b>Issue Type (Non key/Key/Urgent)</b>
East Finchley CPZ	Following their meeting in November 2017, the Committee requested that the Strategic Director for Environment to report back the findings of the consultation at a future meeting of this Committee, for a decision to be made on the way forward.	Strategic Director of Environment	Non-key
Safety Measures at the Junction of Buxted Road and Ashurst Road N12.	At the 16th February 2017 meeting of the committee, it was agreed that a report will be brought back to a future meeting concerning the use of traffic islands and any other potential traffic calming/safety measures that can be used to address the issues identified at the junction of Buxted Road and Ashurst Road N12.	Strategic Director of Environment	Non-key
Friary Road Traffic Management Issues	At their meeting on 2 August 2017, Committee received a report on Friary Road Traffic Management issues. Following consideration of the report, the Committee resolved to approve up to £3,000 to allow monitoring to take place as to the effectiveness of the implementation of recommendations 1 and 2, a report back on the impact of recommendations 1 and 2 and advise on further options.	Strategic Director of Environment	Non-key

<b>Title of Report</b>	<b>Overview of decision</b>	<b>Report Of (<i>officer</i>)</b>	<b>Issue Type (Non key/Key/Urgent)</b>
Speeding in Church Lane, N2.	At their meeting in November 2017, the Committee considered a Member's Item in the name of Cllr. Moore on the topic of speeding in Church Lane, N2. The Committee resolved to await the outcome of speed restriction introduction in adjacent roads. Following this the issue would be discussed by the Committee in mid-2018.	Strategic Director of Environment	Non-key
20 MPH Scheme (including zebra crossing) St Agnes Catholic Primary School and Childs Hill Primary Schools – Update	At their meeting in November 2017, the Committee considered a report on 20 MPH scheme (including zebra crossing) for St Agnes Catholic Primary School and Childs Hill Primary School. Following the consideration of the report, the Committee resolved to consider the feasibility of introducing a width restriction on Summerton Road and to ask Officers to report back to the Committee.	Strategic Director of Environment	Non-key

<b>Title of Report</b>	<b>Overview of decision</b>	<b>Report Of (<i>officer</i>)</b>	<b>Issue Type (Non key/Key/Urgent)</b>
Temple Fortune Area NW11 – Proposed Waiting Restrictions	At their November 2017 meeting, the Committee considered this report and resolved that all Golders Green Ward proposals be deferred to enable discussion with residents of specific locations and objections as highlighted in the report and to come back to Committee at a later date to make a determination.	Strategic Director of Environment	Non-key

This page is intentionally left blank